

Quick Reference Instructions of COVID-19 IgG/IgM Rapid Test Device

- For use under the Emergency Use Authorization (EUA) only.
- The user should be trained in the procedure. Wear the appropriate protective attire for your safety when handling patient samples. This test is point of care for fingerstick whole blood specimens only.
- Read the complete Quick Reference Instructions before performing the test. For technical assistances, please call (800) 854-8446.
- There should be a blue line in the control region (next to "C") before testing, discard the device if there is no blue line.
- Due to the risk of false positive results, confirmation of positive results should be considered using second, different IgG or IgM assay.

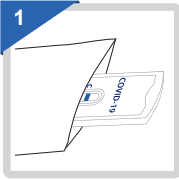

1. Remove the test cassette from the sealed pouch and use it as soon as possible.

Before you begin

- Refer to the package insert for more information
- Read through the entire Quick Reference Instructions before beginning a test
- Bring test components show below to room temperature before starting

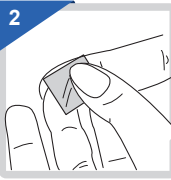

2. Clean the puncture site with the alcohol prep pad provided.

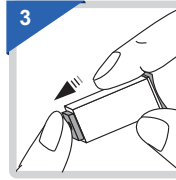

3. Remove the cap. Push the safety lancet firmly against the puncture site.

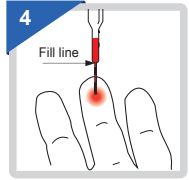

4. Draw the specimen into the test cassette above the fill line.

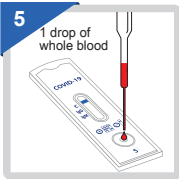

5. Transfer 1 drop of specimen into the specimen well.

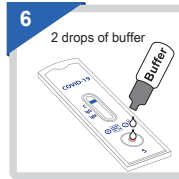

6. Add 2 drops of buffer and start the timer. Wait for the blue line change to red line.

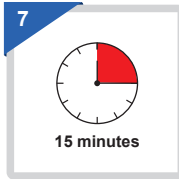

7. Read result at 15 minutes after adding buffer, do not interpret the result after 20 minutes.

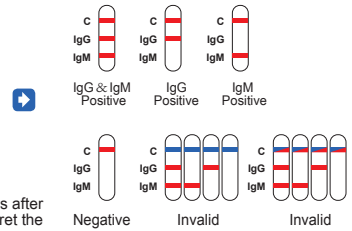

Quick Reference Instructions of COVID-19 IgG/IgM Control

For Positive control

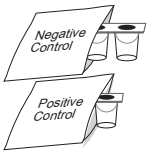

1. Remove the control well from the sealed pouch and use it as soon as possible.



2. Open the positive control and one of the negative control.

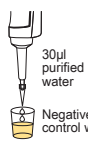

3. Add 30µl purified water into the negative control well by micropipette.



4. Draw the liquid up and down for 5-10 times to vigorously mix.



5. Transfer all the mixed liquid of negative control into the positive control well.



6. Draw the liquid up and down for 5-10 times to vigorously mix and wait to be used.

For negative control



1. Remove the control well from the sealed pouch and use it as soon as possible.



2. Open one of the negative control.



3. Add 30µl purified water into the negative control well by micropipette.

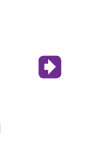

4. Draw the liquid up and down for 5-10 times to vigorously mix and wait to be used.

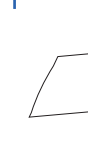

• Remove the test cassette from the sealed pouch and use it as soon as possible.



For negative control

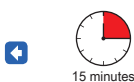

• Read result at 15 minutes after adding buffer, do not interpret the result after 20 minutes.



• Add 2 drops of buffer and start the timer. Wait for the blue line change to red line.



• Transfer 1 drop of positive or negative control solution into the specimen well.



• Draw the positive or negative control solution into the fill line.